

2000035156 A3

BRITAX RÖMER Child Safety EMEA
www.britax-roemer.com | hello@britax-roemer.com

2. Product description

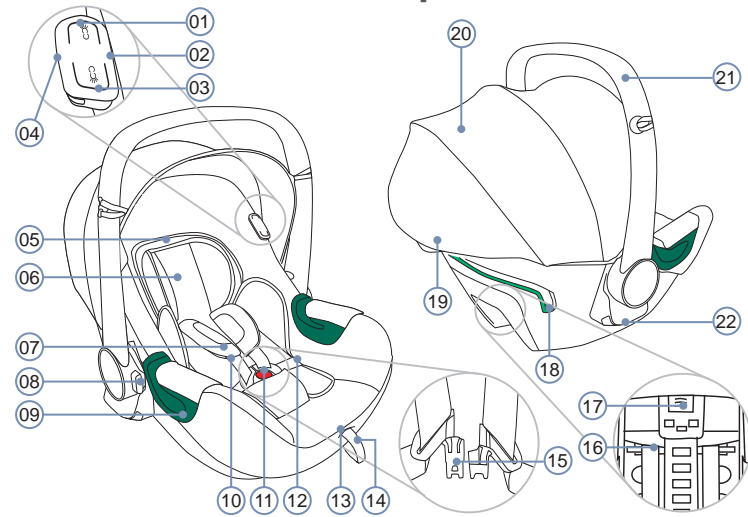

- | | |
|--------------------------------|----------------------------|
| 01 Top button | 13 Adjustment button |
| 02 USB-C charging connection | 14 Adjustment belt |
| 03 Bottom button | 15 Buckle tongues |
| 04 Red LED | 16 Shoulder straps |
| 05 Headrest | 17 Release button |
| 06 Seat reducer | 18 Light-green belt holder |
| 07 Shoulder pad | 19 Grey release button |
| 08 Swivel button | 20 Sunshade |
| 09 Dark-green belt guides | 21 Handle |
| 10 Shoulder strap | 22 Hold points |
| 11 Harness buckle (red button) | |

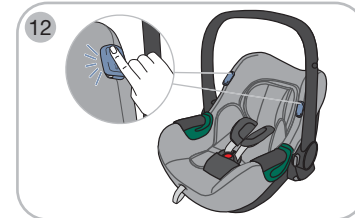
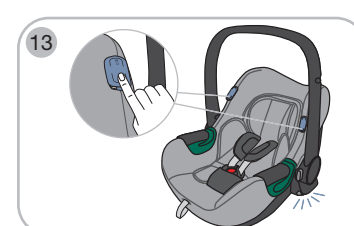
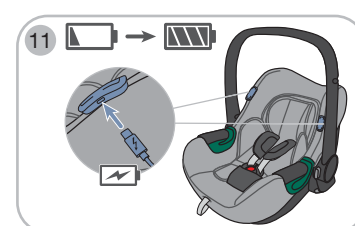

Handle

You can engage the handle in three positions: A, B and C:
A - For carrying and for transport in your car.
B - For placing your child inside
C - For setting the infant carrier down safely outside the car.

Adjust handle 1

- ▶ Hold down both swivel buttons.
- ▶ Move handle to desired position.
- ▶ Release swivel button.
- ▶ Ensure that the handle is locked in place.

Seat reducer

Use the seat reducer when your child baby is still very small.

Insert seat reducer 2

- ▶ Press red button to open the harness buckle.
- ▶ Place seat reducer in the infant carrier.
- ☞ The part filled with the foam blocks must be facing downwards.
- ▶ Thread the lower part of the seat reducer underneath the shoulder straps.
- ▶ Make sure that the seat reducer is in contact with the backrest of the infant carrier.

Shoulder straps

A properly adjusted headrest ensures optimal protection for the child your infant carrier. The headrest is correctly positioned when the outlet slots of the shoulder straps are roughly two finger-widths (25 mm) below the child's shoulders.

Loosening the shoulder straps 4

- ▶ Hold adjustment button down.
- ▶ Pull both shoulder straps forwards.
- ▶ Release adjustment button.

Adjust shoulder straps 3

- ▶ Press red button to open the harness buckle.
- ▶ Press and slide the release button on the shoulder straps.
- ☞ The release button is on the back of the infant carrier.
- ☞ The outlet slots for the shoulder belt must be roughly two finger-widths (25 mm) below the child's shoulders.
- ▶ Ensure that adjustment button on the shoulder straps is locked in place.

Tighten shoulder straps 5

- ▶ Pull adjustment belt out straight.
- ☞ Do not pull adjustment belt upwards or downwards.

Buckle child in

- ▶ Loosen the shoulder straps. See chapter "Shoulder belt" page 1. 4
- ▶ Press red button to open the harness buckle. 6
- ▶ Move harness buckle forwards.
- ▶ Place child in final carrier.
- ☞ Avoid thick clothing under the belt.
- ▶ Pass shoulder straps over the child's shoulders.

⚠ **WARNING!** Ensure that the shoulder straps **are not** twisted or reversed.

- ▶ Bring both buckle tongues together. 7
- ▶ Lock buckle tongues in harness buckle.
☞ Buckle tongues audibly lock.

- ▶ Pull adjustment belt out straight. 5
- ☞ **Do not** pull adjustment belt upwards or downwards.
☞ Place shoulder straps tight to the child's body.

⚠ **WARNING!** Ensure that the hip straps are positioned as low as possible over your child's hips.

Unbuckle child 8

- ▶ Press red button to open the belt lock.
- ▶ Remove child.

Sunshade

The sunshade protects your child's head from sunlight. It can be folded open and closed with the handle.

Remove sunshade 9

- ▶ Release push buttons on the side.
- ▶ Remove elastic seam edge.
- ▶ Hang reference loops on both sides of the handle.
- ▶ Attach sunshade hooks.

Attach sunshade 10

- ▶ Attach reference loops left and right of the handle.
- ▶ Pull the elastic seam over the head end of the infant carrier.
- ▶ Secure the elastic seam at the side with the fasteners.

Charge battery 11

☞ Only available for BABY-SAFE iSENSE.

⚠ **WARNING!** Risk of explosion and acid burn. Unintended use can lead to damage to the battery.

- ▶ **Do not** immerse battery in water.
- ▶ Keep battery away from fire.
- ▶ Protection battery against high temperatures. Note the recommended use and storage temperatures.
- ▶ **Never** remove, modify or replace battery. It can explode or release poisonous substances.
- ▶ If the battery is damaged or has deformations or cracks, **do not** dismantle it or modify its structure.
- ▶ If the battery loses electrolytes, avoid touching the extremely corrosive liquid. If there is contact with the eyes or skin, see a doctor.

Fully charge the battery before the first use. The first charging process enables the light functions. Use the charging cable provided when charging the battery. This guarantees the stated life of the battery. Only charge the battery in ambient temperatures of +10 to +40° C. Do not insert foreign objects into the charging socket. The battery has a life of at least 500 charge cycles.

- ▶ Connect charging cable to one of the two USB-C charging connections.
- ☞ Each control element has a USB-C charging connection.

⚠ **WARNING!** Risk of strangulation. **Do not** lead the charging cable across the child seat. Lead the charging cable away from the child seat.

- ▶ Connect charging cable to a 5V USB adapter.
☞ If the red LED is permanently on, the battery is charged.
☞ If the red LED is no longer on, the battery is fully charged.

- ▶ Remove charging cable and store out of reach of children (e.g. in the glove compartment).
- ▶ Recharge the battery as soon as the charge level is low.
- ☞ You can check the charge level. Press any button. If the red LED slowly flashes three times, the charge level capacity is low.
- ☞ The interior lighting, the installation light and the safety light can be used during charging.

Interior lighting 12

- ☞ Only available for BABY-SAFE iSENSE.
- ☞ Operation of the BABY-SAFE iSENSE differs from the DUALFIX iSENSE. The interior lighting can be controlled manually both with the left and right

control element. In addition, delayed switching-off can be activated. The light switches off automatically after a few minutes.

Switch light on and off

- ▶ Briefly press the top button.
☞ Light switches on.
- ▶ Briefly press the top button again within a few minutes.
☞ Brightness is increased.
- ☞ The brightness can be increased twice. Pressing the top button again switches off the light.
- ☞ If the light is on and you press the top button again after a few minutes, the light goes out.

Activate delayed switching on

- ▶ Hold down the top button until the light flashes once.
☞ Delayed switch-off is enabled.
- ☞ The light switches off automatically after a few minutes.

Installation and safety light 13

- ☞ Only available for BABY-SAFE iSENSE.
- ☞ Automatic mode can be activated after the first charging.

The installation light aids with the installation of the product. You are visible to other drivers with this safety light. Both lights are switched on and off automatically by sensors. The sensors react to movement, darkness and to the compatible station FLEX BASE iSENSE, as well as to compatible BRITAX RÖMER adapters for the SMILE III pushchair.

Activate automatic mode

- ▶ Briefly press the bottom button.
☞ Automatic mode is active.

☞ If you install the infant carrier with a 3-point seat belt, we recommend disabling automatic mode.

Switch on light manually

You can switch on both the installation light and the safety light manually with the left and right control element. To be able to switch on the light manually, automatic mode must be active. As soon as you remove the child seat from a station or a pushchair, manual mode is disabled.

- ▶ Briefly press the bottom button.
☞ Safety light turns on.
☞ Installation light turns on.
- ▶ Briefly press the bottom button again.
☞ Safety light remains on.
☞ Installation light turns off.
- ▶ Briefly press the bottom button again.
☞ Safety light turns off.
☞ Installation light turns on.
- ▶ Briefly press the bottom button again.
☞ Manual mode is disabled.
☞ Automatic mode is active.

Disable automatic mode

- ▶ Hold down the bottom button for two seconds.
☞ Automatic mode is disabled.
☞ Installation and safety light are disabled.

Switch off installation and safety light manually

☞ See "Disable automatic mode".

3. Intended use

This product has been designed, tested and approved according to the requirements of the European Standard for Child Safety Equipment R129/03. This product may only be used to secure a child in the vehicle, in an aircraft or on a pushchair.

	Rear-facing	Never use the product forward-facing.
Body height	40 - 83 cm	
Body weight	Maximum 13 kg	

1. About this document

⚠ **WARNING!** This operating manual is a component of the product and contributes to its safe use. **Non-compliance may lead to serious or even fatal injuries. If in doubt, do not use product and immediately contact your retailer.**

- ▶ Read operating instructions.
- ▶ Keep with the product for reference.
- ▶ If the product is given to third parties, include the operating instructions with the product.

Contact information

If there are any questions, please get in touch.

BRITAX RÖMER Child Safety EMEA
www.britax-roemer.com
hello@britax-roemer.com

BRITAX RÖMER Kindersicherheit GmbH
Theodor-Heuss-Strasse 9
89340 Leipheim
Germany

BRITAX Excelsior Limited
1 Churchill Way West
Andover
Hampshire SP10 3UW
United Kingdom

BRITAX Nordiska Barn AB
Jörgen Kocksgatan 4
SE-211 20 Malmö
Sweden



+49 (0) 8221 3670 199

+44 (0) 1264 386034

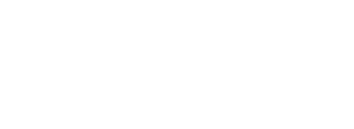
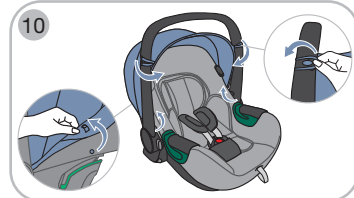
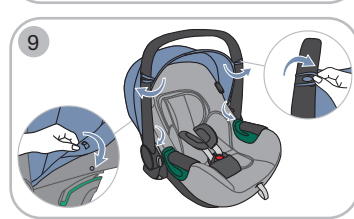
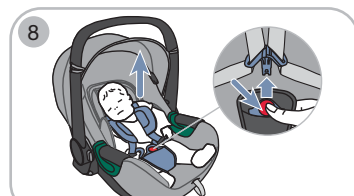
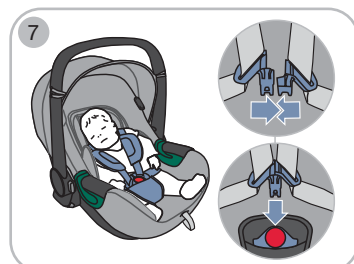
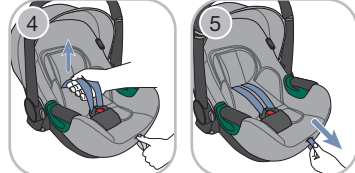
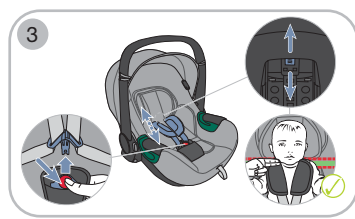
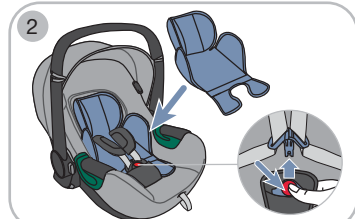
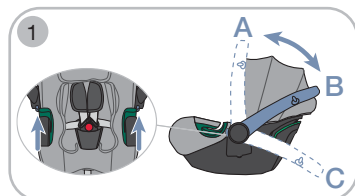

4. Safety information

Risk of injury from damaged child seat

In the event of an accident at a collision speed of more than 10 km/h, the child seat may be damaged without the damage being immediately visible. Serious injuries may result from another accident.

- ▶ Replace product following an accident.
- ▶ Have damaged product inspected (even if it has fallen onto the ground).
- ▶ Regularly check all important parts for damage.
- ▶ Ensure that all mechanical components work properly.
- ▶ Never lubricate or oil parts of the product.
- ▶ Properly dispose of the damaged product.

Risk of burns from hot components

Components of the product can become hot in direct sunlight. Children's skin is sensitive and maybe harmed as a result.

- ▶ Protect the product against intensive direct sunlight when not in use.

Risk of injury if installed incorrectly

If the product is installed or used other than as described in the operating instructions, serious or even fatal injuries may result.

- ▶ Only use on a car seat facing the direction of travel.
- ▶ Note and follow the instructions in the vehicle handbook.

Risk of injury from front airbag

Airbags are designed to protect adults. The use of a front airbag with an infant carrier can lead to fatal injuries.

- ▶ Disable front airbag.
- ▶ Note and follow the instructions in the vehicle handbook.

Risk of injury during use

The temperature in a vehicle can rise dangerously quickly. In addition, it is dangerous to leave the vehicle on the side facing the street.

- ▶ Never leave a child unsupervised in the vehicle.
- ▶ Only fasten or remove seat module from the footpath-side.

Risk of injury from unsecured objects

In the case of an emergency stop or accident, unsecured objects or people may cause injury to other occupants in the vehicle.

- ▶ **Never** secure your child by holding them tightly on your lap.
- ▶ Secure backrests of the vehicle find (e.g. engage foldable rear).
- ▶ Secure all heavy or sharp-edged objects in the vehicle (e.g. on the parcel shelf).
- ▶ Do not place objects in the foot well.
- ▶ Ensure that everyone in the vehicle has their seatbelts fastened.
- ▶ Ensure that the product is always secured when it is in the car, even if no baby is being transported.

Risk of injury due to missing seat cover

The seat cover is an integral safety component of the child seat. If the seat cover is not used, this may lead to serious or even fatal injuries.

- ▶ Only use original BRITAX RÖMER replacement seat covers.
- ▶ Replacement seat covers are available from your retailer.

Risk of injury to spine

An infant carrier is not intended to hold a baby for prolonged periods of time. The semi-recumbent position in the infant carrier will always put a strain on the child's spine.

- ▶ Take breaks on long journeys.
- ▶ Take the child out of the infant carrier as often as possible.
- ▶ Do not keep your child in the infant carrier once it has been removed from the car.
- ▶ Only suitable for short journeys as a travel system with a pushchair. For longer journeys with a pushchair, we recommend using a carry cot or stroller.

Avoid damaging the product

- ▶ Product is not a toy.
- ▶ Ensure that the product is not trapped between hard objects

(car door, seat rails, etc.).

- ▶ Keep product away from: Damp, moisture, liquids, dust and salt spray.
- ▶ Do not lean heavy objects on the product.

Risk of injury as a result of prohibited modification

This approval is invalidated if you make any modifications to this product. Changes may only be made by the manufacturer. The stickers on the product are an important component of the product.

- ▶ Do not make any changes.
- ▶ Do not remove stickers.

Avoid damaging the vehicle

- ▶ Sensitive car seat covers may be damaged.
- ▶ Use a BRITAX RÖMER child seat base. These are available separately.

5. Use in the vehicle

Secure infant carrier with belt A (Universal Belted)

1. Select suitable seat

- ⚠ WARNING! Note and follow the vehicle's operating instructions.
- ⚠ WARNING! **Never** secure the infant carrier with a 2-point seat belt.
- 🔧 Car seats with i-Size approval are suitable.
- 🔧 Car seats with a 3-point seat belt, which are approved according to ECE R16 (or comparable standard) are suitable.
- 🔧 Only car seats arranged in the direction of travel are approved for use.
- 🔧 Front airbag of the selected car seat is disabled.

2. Position infant carrier 14

- 🔧 Child is strapped into the infant carrier. See chapter "Strap in child" page 1.
- 🔧 Shoulder straps are adjusted correctly. See chapter "Shoulder belt" page 1.
- 🔧 Handle is adjusted to position A. See chapter "Handle" page 1.
- ▶ Position infant carrier on the car seat facing away from the direction of travel.
- 🔧 Child faces backwards.
- ▶ Check distance to front seat.
- 🔧 Distance must be more than 10 cm.
- ▶ If the distance between the infant carrier and the front seat is less than 10 cm, select a different seat position.

3. Fasten lap belt 15

- ▶ Pass the seat belt over the infant carrier.
- ▶ Lock buckle tongues in seat belt lock.
- ▶ Insert lap belt into the dark-green belt guides on both sides of the infant carrier edge.
- 🔧 Do not twist lap belt.
- ▶ Pull the diagonal belt.
- 🔧 Lap belt is tight.
- ▶ Check position of the seat belt lock. If the seat belt lock is in or in front of the dark-green belt guide, this seat is **not** approved. Select a different seat.
- 🔧 If you have any doubts about installing the seat correctly, please contact your retailer.

4. Fasten diagonal belt 16

- ▶ Pull the diagonal belt behind the head end of the infant carrier.
- ▶ Insert the diagonal belt into the light-green belt holder.
- 🔧 Do not twist the diagonal belt.
- ▶ Tighten diagonal belt.

Check before every use

- Infant carrier is secured against the direction of travel.
- If the vehicle has a front airbag, it is disabled.
- Infant carrier is secured with a 3-point seat belt.
- The lap belt passes through both dark-green belt guides.
- The diagonal belt passes through the light-green belt holder.
- The vehicle seat lock is **neither** in **nor** in front of the dark-green belt guide.
- The seat belt is pulled tight and **not** twisted.
- Handle is in the upper position A.
- Shoulder belts are correctly adjusted.
- Child is correctly strapped in.

Remove infant carrier from vehicle 17

- ▶ Take diagonal belt out of the light-green belt holder.
- ▶ Open vehicle belt lock.
- ▶ Remove lap belt from the dark-green belt guides.
- 🔧 The infant carrier can now be removed.

- ⚠ WARNING! The infant carrier must always be secured when it is in the vehicle, even if no child is being transported.

Secure infant carrier with base station B (i-Size universal ISOFIX)

- ⚠ WARNING! This product is approved exclusively for use with the FLEX BASE iSENSE base station.
- ▶ Note and follow instructions for the FLEX BASE iSENSE.
- 🔧 Fastening the infant carrier is described in the instructions for the FLEX BASE iSENSE.

6. Use with pushchair

This infant carrier can be used as a Travel System on all pushchair frames which are approved for use with BRITAX RÖMER infant carriers. Exclusively private use is permitted .

- ▶ Only transport one child.
- ▶ Always leave the child strapped into the infant carrier.
- ▶ **Never** hold the infant carrier in order to lift or push the pushchair.
- ▶ **Do not** use in combination with other pushchair frames.

Secure infant carrier to pushchair 18

- ▶ Note and follow the instructions for the pushchair.
- ▶ Lock the pushchair brake.
- ▶ Position infant carrier facing **against** the direction of travel above the pushchair.
- ⚠ WARNING! Never try to attach the infant carrier to the pushchair in a forward-facing position.
- ▶ Lock the hold points on both sides of the infant carrier into the fastening tongues.
- 🔧 Audible locks.

- ▶ Check that the infant carrier is securely locked in place. Try to lift the infant carrier. If it cannot be lifted from the pushchair, the infant carrier is securely fastened in place.

Release infant carrier from pushchair 19

- ▶ Note and follow the instructions for the pushchair.
- ▶ Lock the pushchair brake.
- ▶ Ensure that the handle is locked in position A. See chapter "Handle" page 1.
- ▶ Pull and hold grey unlocking button.
- ▶ Hold infant carrier tight and release from the pushchair.

7. Use in an aircraft

This product may only be used on an aircraft seat that has been approved by the airline for this purpose.

- 🔧 A suitable aircraft seat faces the direction of travel.
- 🔧 A suitable aircraft seat **does not** have an airbag.

In case of emergency evacuation

- ▶ Remove child from the infant carrier.
- ▶ Follow the instructions from the cabin crew.

During the flight

- ▶ Take the child out of the infant carrier as often as possible.
- 🔧 Relax its spine outside the take-off and landing phases. For children younger than 4 months, use the airline's cots.
- ▶ Ensure that the product is always secured when it is in the aircraft, even if no child is being transported.
- ▶ If the seat-belt sign lights up, secure the child in the infant carrier.

Secure infant carrier in the aircraft 20

- ▶ Position infant carrier on the seat facing away from the direction of travel.
- ▶ Ensure that the handle is in the upper position A.
- ▶ Place the seat belt into the two dark-green belt guides.
- ▶ Close seat belt.
- 🔧 Note the airline's safety instructions.

- ▶ Pull the end of the seat belt.
- 🔧 Seat belt is tight.

- ⚠ WARNING! The seat belt must never be placed inside the dark-green belt guides.

8. Cleaning and care

- ▶ Clean plastic parts with soapy water.
- ▶ Do not use abrasive cleaning agents (e.g. solvents).

Clean cover

Remove cover 21

- ▶ Remove sunshade.
- 🔧 Chapter "Sunshade" page 1.
- ▶ Press red button to open the belt lock.
- ▶ Release push buttons on the shoulder pads.
- ▶ Pull cover up from the headrest.
- ▶ Loosen cover from the edge of the infant carrier.
- ▶ Carefully loosen cover from the control elements (BABY-SAFE iSENSE).
- ▶ Remove cover.

- ⚠ WARNING! **Never** use product without cover.

Wash cover

- ▶ Note information on the washing label.

Attach cover

- ▶ Proceed as above in the reverse order.

Look after harness buckle

Dirt and foreign objects can impair the function of the harness buckle. Look after the harness buckle if the buckle tongues only lock into the harness buckle with difficulty if at all.

Remove harness buckle 22

- ▶ Tip infant carrier backwards.
- ▶ Slide the metal plate of the harness buckle upright through the belt slot.

Look after harness buckle

- ▶ Soak the harness buckle for an hour in warm water with cleaning agent.
- ▶ Rinse harness buckle and leave to dry.

Fit belt lock 23

- ▶ Slide the metal plate of the harness buckle upright through the belt slot.
- ▶ Note direction.
- ▶ Check fastening by pulling hard on the harness buckle.

9. Temporary storage of product

If you do not use the product for a longer period, please note the following information.

- ▶ Store product in a secure and dry location.
 - ▶ Maintain storage temperature between 20 and 25 °C.
 - ▶ **Do not** lean heavy objects on the product.
 - ▶ **Do not** store product directly next to sources of heat or in direct sunlight.
- The following also applies to the BABY-SAFE iSENSE:
- ▶ Disable automatic mode.
 - ▶ Charge battery before temporary storage.
 - ▶ Fully charge the battery at least every 12 months.

10. Disposal

Please follow the disposal regulations applying in your country. Do not dismantle this product.

The BABY-SAFE iSENSE must be disposed of with electrical waste.

